

# Lexmark X850e / X854e

Intelligent departmental MFPs.

uncomplicate  
the way you work.



Mono Laser Multifunction Printers

**LEXMARK**<sup>™</sup>



## Lexmark X850e and X854e: An affordable path to workgroup efficiency

Lexmark's high-performance X850e and X854e monochrome wide-format MFPs are specially designed to meet the needs of your rigorous business applications.

With a time-to-first-page of less than 5 seconds, plus lightning-fast output speeds of 35 pages per minute for the X850e and 55 pages per minute for the X854e, your workgroups will now spend less time waiting and more time working.

The Lexmark X850e and X854e can take up to 3,100 sheets of paper input at once and with the option to take a massive 5,100 sheets, so you spend much less time refilling. With both offering an optional finisher for stapling, stacking and hole punching, you now gain the uninterrupted performance you need to stay productive.

Taking care of all your printing, copying, scanning and faxing needs, these intelligent, departmental units are designed to do it all, making them the essential tools for your large workgroups to Work Easy, Work Smart and Work Fast.

## Now showing on the big screen...

Boasting Lexmark's unique e-Task colour touch screen, the X850e and X854e are easy to use, even for first-timers.



e-Task colour  
touch screen

With a common screen across all new colour touch-screen MFPs, users can become familiar with the interface quickly, reducing training time and increasing productivity.

Providing an extremely practical way to access even the most advanced features, the intuitive and fully customisable touch screen is your gateway to greater business efficiency. Customise your screen to access electronic forms or create short cuts to simplify and automate complex business processes.





**Fast! Up to 55ppm**  
Copy/print speed improves productivity by reducing waiting times



**Colour scanning** At the touch of a button. The duplex ADF gives users the option to scan originals in full colour, increasing workflow capability



**Easy to use** e-Task colour touch screen minimises the learning curve



**USB** Flash drive interface for scanning and printing images and PDFs



**Fax modem standard**  
Eliminates need to purchase additional fax accessory

## Scanning and copying made easy

Sporting a wide-format A3 colour flatbed scanner, the Lexmark X850e and X854e are perfect for scanning and copying big documents. You can even conveniently scan straight to a USB drive or preview scans on the LCD screen so you can check you're sending the right material and the orientation is correct.

If you need to scan double-sided colour originals, simply place your stack on the 75-page duplexing Automatic Document Feeder, touch the screen and go! You can scan up to 55 pages per minute in mono and 27 pages per minute in colour, minimising wait times and maximising work times.

If you need to make a copy and a large print job is in progress, you can pause the job to make your copy, then restart the print job once you're done, giving priority to the user at the device and maintaining office productivity.



## Solutions-ready

Lexmark has a range of customisable software solutions that can be coupled with the X850e and X854e to take your workflow efficiency to new levels.

The X850e and X854e are equipped with Lexmark's Embedded Solutions Framework, offering you network-friendly, native support for Lexmark's wide range of enterprise solutions such as OptraForms, ImageQuick, DLE applications and many others.

Do you need to scan, process and route documents on an enterprise scale? Lexmark Document Distributor Enterprise 4.0 lets you do so, offering clustering, management and security features required by the largest business environments.

How about capturing key business documents at the point of transaction? We have several tools that can let your business reap the benefits of distributed capture.

## Keeping your critical information safe

The Lexmark X850e and X854e offer specially designed security features to ensure your critical information remains secure.

Your printer network can be managed comprehensively and securely via Lexmark's MarkVision software. You can rest assured all your valuable network data is locked up tight. This robust system is designed for enterprise-level security, including disk wiping, encryption and physical cable-lock protection.

Even with their long list of advanced security features, the Lexmark X850e and X854e are still user-friendly, with users only requiring standard network information to log-in when security is enabled.

These flexible security features translate to safe network communications and secure information storage.

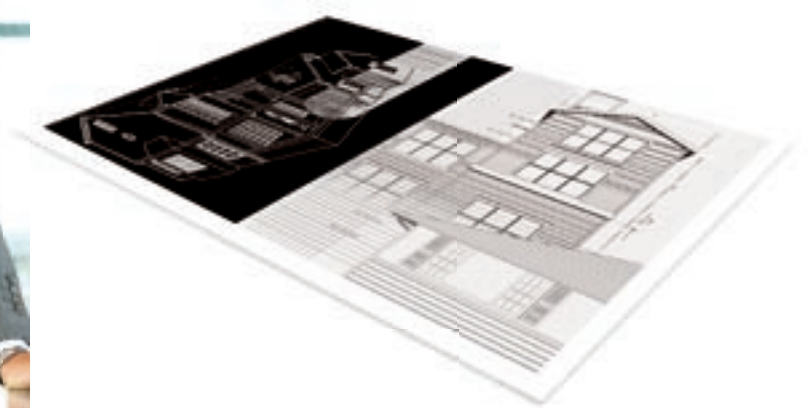

# Technical Specifications

## Print

<b>Print technology</b>	Monochrome Laser
<b>Print speeds</b>	X850e - Up to 35ppm, X854e - Up to 55ppm
<b>Time to first page</b>	4.9 seconds
<b>Resolution</b>	600 x 600 dpi, 1200 x 1200 dpi, 2400 Image Quality
<b>Connectivity standard</b>	USB, Parallel and Ethernet
<b>Compatibility</b>	PCL 6 Emulation, PostScript 3, Personal Printer Data Stream (PPDS) Migration Tool, PDF v1.5 Emulation
<b>Direct print formats</b>	JPEG, TIFF, GIF, BMP, PNG, PCX, DCX, PDF, HTML
<b>Font selection</b>	PCL 6 - 84 scalable, 2 bitmapped; PostScript 3 - 158 scalable; PPDS - 39 scalable, 5 bitmapped; PDF 1.5
<b>Optional solutions</b>	Bar Code Card, IPDS and SCS/TNe Card, Forms Card - Single Byte, Forms Card - Simplified Chinese, PRESCRIBE Card, Font cards - Korean, Japanese, Simplified Chinese, Traditional Chinese

## Copy

<b>Copy speeds</b>	X850e - Up to 35ppm, X854e - Up to 55ppm
<b>Resolution</b>	600 x 600 dpi
<b>Maximum copies</b>	999
<b>Features</b>	Custom Job Build, Job Cancel, Job Interrupt, Job Preview
<b>Reduce / Enlarge</b>	25 to 400%
<b>Copy collation</b>	Supported
<b>Paper save functions</b>	2 Up Portrait, 2 Up Landscape, 4 Up Portrait, 4 Up Landscape, Booklet Creation
<b>Copy enhance quality features</b>	Background Removal, Contrast, Shadow Detail, Darkness, Date/Time Stamp, Message Overlay, Paper Saver

## Scan

<b>Scanner type</b>	Colour/Mono Flatbed Scanner with ADF
<b>Scanner technology</b>	Charge Coupled Device (CCD)
<b>Connectivity standard</b>	Ethernet
<b>Resolution</b>	600 x 600 dpi (Mono), 600 x 300 dpi (Colour)
<b>ADF type</b>	Recirculating Duplex ADF with C-Path
<b>Scan destinations</b>	Network TWAIN, USB Thumbdrive, E-mail, FTP, LDSS, Scan to PC
<b>Reduce / Enlarge</b>	25 to 400%
<b>File formats</b>	TIFF, JPEG, PDF
<b>Directory access</b>	LDAP Lookup, Microsoft Exchange, Custom Accounts
<b>Scan area</b>	Flatbed - Maximum 297 mm x 432 mm
<b>Scan preview</b>	Available
<b>Standard input</b>	75 sheets
<b>Standard output</b>	75 sheets - with Job Build enabled additional pages can be scanned as one document
<b>TWAIN Drivers</b>	Provide remote scanning capabilities to Windows and Macintosh. Network SANE drivers provide remote scanning capabilities for Linux workstations. These drivers allow TWAIN (or SANE) compatible applications to acquire raw scan data directly from a networked Lexmark multifunction printer.

## Fax

<b>Transmission speed</b>	33.6 kbps
<b>Fax redirect</b>	To another fax, eMail, FTP, LDSS
<b>Fax from PC</b>	via PostScript 3 driver
<b>Speed dials</b>	Greater than 500, based on 10-digit phone number
<b>Directory access</b>	LDAP Lookup, Microsoft Exchange, Custom Accounts
<b>Compatible with following fax servers</b>	Biscom, Equisys, Omttool, RightFax and more
<b>Storage</b>	Up to 20 GB access of 80 GB HDD
<b>Fax backup</b>	via HDD
<b>Additional features</b>	Group fax, Delayed send, Broadcast send

## Other Specifications

<b>Processor</b>	625 MHz
<b>Memory</b>	Standard - 256 MB, Maximum - 768 MB, Optional - 128 MB, 256 MB and 512 MB
<b>Hard disk drive</b>	80+ GB
<b>Hard drive type</b>	3.5" PC Internal Drive, UltraDMA 7200 RPM
<b>Optional flash memory</b>	32 MB or 64 MB via Flash Memory card
<b>Duty cycle</b>	X850e - 150,000 pages per month. X854e - 300,000 pages per month
<b>Standard input</b>	3,000 sheets + 100 sheet MPF
<b>Maximum input</b>	5,100 sheets
<b>Standard output</b>	500 sheets
<b>Maximum output</b>	3,800 sheets
<b>Paper handling options</b>	500-sheet Drawer, 2000-sheet High Capacity Feeder, Finisher
<b>Media supported</b>	Card Stock, Envelopes, Paper Labels, Plain Paper, Transparencies
<b>Media weights supported</b>	Paper: 64 - 216 gsm. Card Stock: Up to 216 gsm
<b>Paper size</b>	A3, A4, A5, Executive Folio, JIS-B5, Legal, Letter, Statement, Universal, Envelope 10, 73/4, 9, B5, C5, DL
<b>Optional adapter</b>	N4000, N7000 & N8000 series including Gigabit, Wireless options, IEEE 1284-B Parallel Card, RS-232C Serial Card
<b>Option slots</b>	DRAM DIMM, ISP (INA), Firmware Card, Flash Memory Card
<b>Network management software</b>	MarkVision Professional
<b>Operating systems supported</b>	Windows: 2000, NT, Me, XP, Server 2003, 98 2nd Edition, XP Professional x64 Novell Netware: 3.2, 4.2, 5.x and 6.x UNIX: Sun Solaris 7,8,9,10, HP-UX 11.00, 11.1, IBM AIX 5.1,5.2,5.3 Linux: Red Hat Linux 7.3,8.0,9.0, other systems IBM: IBM iSeries and AS/400® Systems with TCP/IP with OS/400 V3R1 or later, using OS400 Host Print Transform
<b>Security features</b>	Printing Lockout, Confidential Print Setup, Disk Encryption, Hard Disk Wiping, Restricted Server List, Digitally Signed Firmware Updates
<b>Warranty</b>	Two Years Onsite Repair <sup>1</sup>
<b>Size (H x W x D)</b>	832 x 640 x 649 (with trays retracted) 832 x 850 x 649 (with trays extended)
<b>Weight</b>	106 kg
<b>Power</b>	Average Power while in Continuous Printing is 760 Watts. Average Power in Standby is 95 Watts. Average Power in Standby with Power Saver on is 25 Watts. Energy Star Qualified
<b>Acoustics</b>	32 dB(A) ready; X850e: 52 dB(A) printing; X854e: 53 dB(A) printing
<b>Part Numbers</b>	X850e - 10D1581, X854e - 10D1582 Ships with 30,000 <sup>2</sup> page Regular Cartridge and 48,000 page Photoconductor Kit with X850e, 70,000 page Photoconductor Kit with X854e <b>Aftermarket Supplies:</b> 30,000 <sup>2</sup> page Regular Cartridge - X850H21G 48,000 page Photoconductor Kit for X850e - X850H22G 70,000 page Photoconductor Kit for X854e - X850H22G 15,000 staples - 25A0013

<sup>1</sup>Local warranty conditions apply. For details please contact your nearest Lexmark office.  
<sup>2</sup>Average standard page yield value declared in accordance with ISO/IEC 19752.



In Australia Lexmark partners with Planet Ark to collect and recycle toner and ink cartridges. Visit [www.lexmark.com.au](http://www.lexmark.com.au) for more details.



Lexmark supports the environment by reducing paper wastage. As one of the many environmental initiatives Lexmark does not pre-print brochures.



Lexmark and Lexmark with diamond design are trademarks of Lexmark International, Inc., registered in the United States and/or other countries.

[www.lexmark.com.au](http://www.lexmark.com.au)

# LEXMARK